

EXTEND BLANKET A MINIMUM OF 3'-0" OVER CREST OF SLOPE. SEE DETAIL 4/12. MINIMUM OF 3'-0" IS NOT AVAILABLE AT THE CREST OF SLOPE OR IF OVERLAND FLOW IS ANTICIPATED FROM UPLAND AREAS. SEE DETAILS 5/12 & 6/12

SLOPE DETAIL
NO SCALE

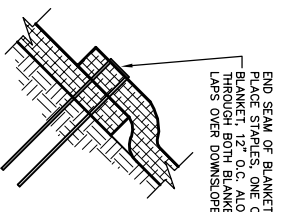

END ROLL OVERLAP
NO SCALE

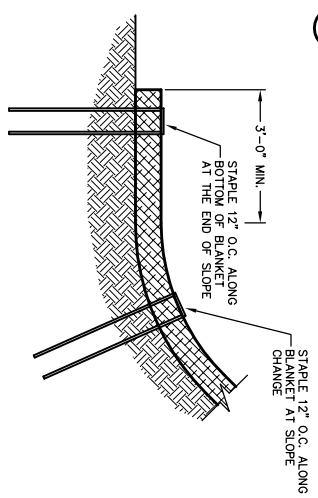

BOTTOM OF SLOPE TERMINATION
NO SCALE



SLOPE CREST ANCHOR METHOD A (NO TRENCH)
NO SCALE
DO NOT NEED TO TRENCH BLANKET IN IF IT CAN BE EXTENDED A MINIMUM OF 3'-0" OVER THE CREST OF THE SLOPE.

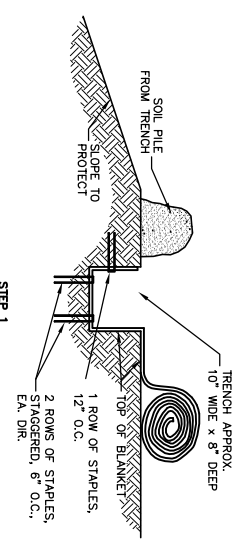

SLOPE TRENCHING METHOD B
NO SCALE
STEP 1
2 ROWS OF STAPLES, STAGGERED, 6" O.C., EA. DIR.
1 ROW OF STAPLES, 12" O.C.
2 ROWS OF STAPLES, STAGGERED, 6" O.C., EA. DIR.

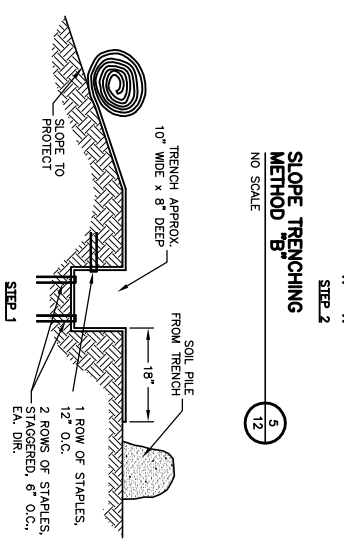
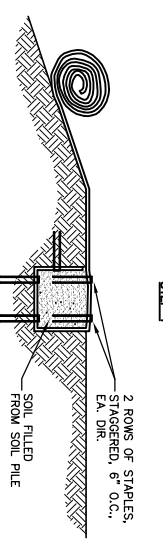

SLOPE TRENCHING METHOD C
NO SCALE
STEP 1
2 ROWS OF STAPLES, STAGGERED, 6" O.C., STAPLES TO BE FLAGGED OUTSIDE OF BLANKET
4" APART
SOIL PILE FROM TRENCH
SOIL FILLED FROM SOIL PILE
STEP 2
1 ROW OF STAPLES, 12" O.C.
2 ROWS OF STAPLES, STAGGERED, 6" O.C., EA. DIR.

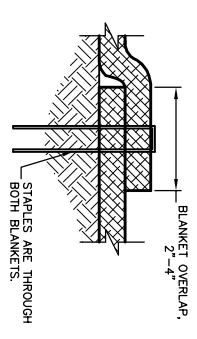

SIDE SEAM OVERLAP STAPLE DETAIL
NO SCALE

- NOTES:**
1. STAPLE PATTERNS ARE DEPENDENT ON SITE CONDITIONS. SEE AEC PREMIER COCONUT™ STAPLE PATTERN GUIDE FOR DETAILS.
 2. E-STAPLE® MAY BE USED IN PLACE OF WIRE STAPLES.

NO.	REV.	DATE	REVISIONS	PROJECT MANAGER BY: APPROVED BY:	AMERICAN EXCELSIOR COMPANY ARLINGTON, TEXAS	SHEET DESCRIPTION AEC PREMIER COCONUT™ SLOPE APPLICATION DETAIL	DATE 5/1/03	SCALE NONE	DRAWN BY: KK	SHEET NO. 12
-----	------	------	-----------	----------------------------------	---	---	-------------	------------	--------------	--------------

